

DETALLE 4 (ELEVACIÓN)
(APOYO DE LARGUERO EN CUMBRERA)

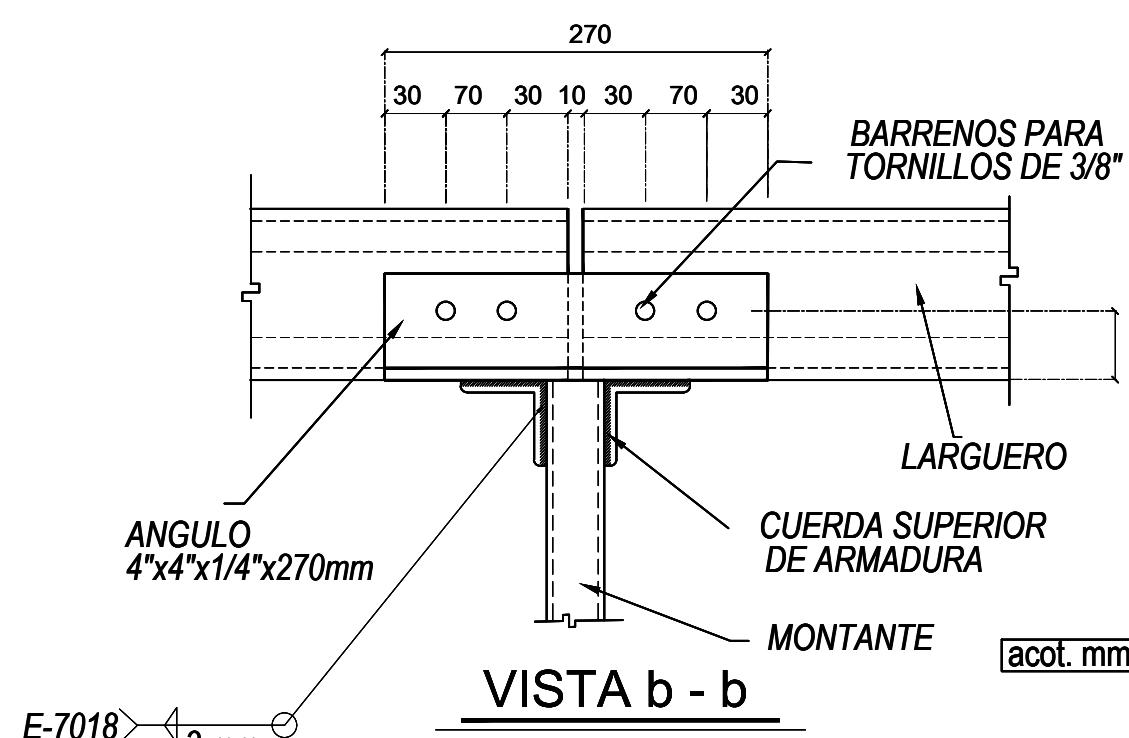

VISTA b - b

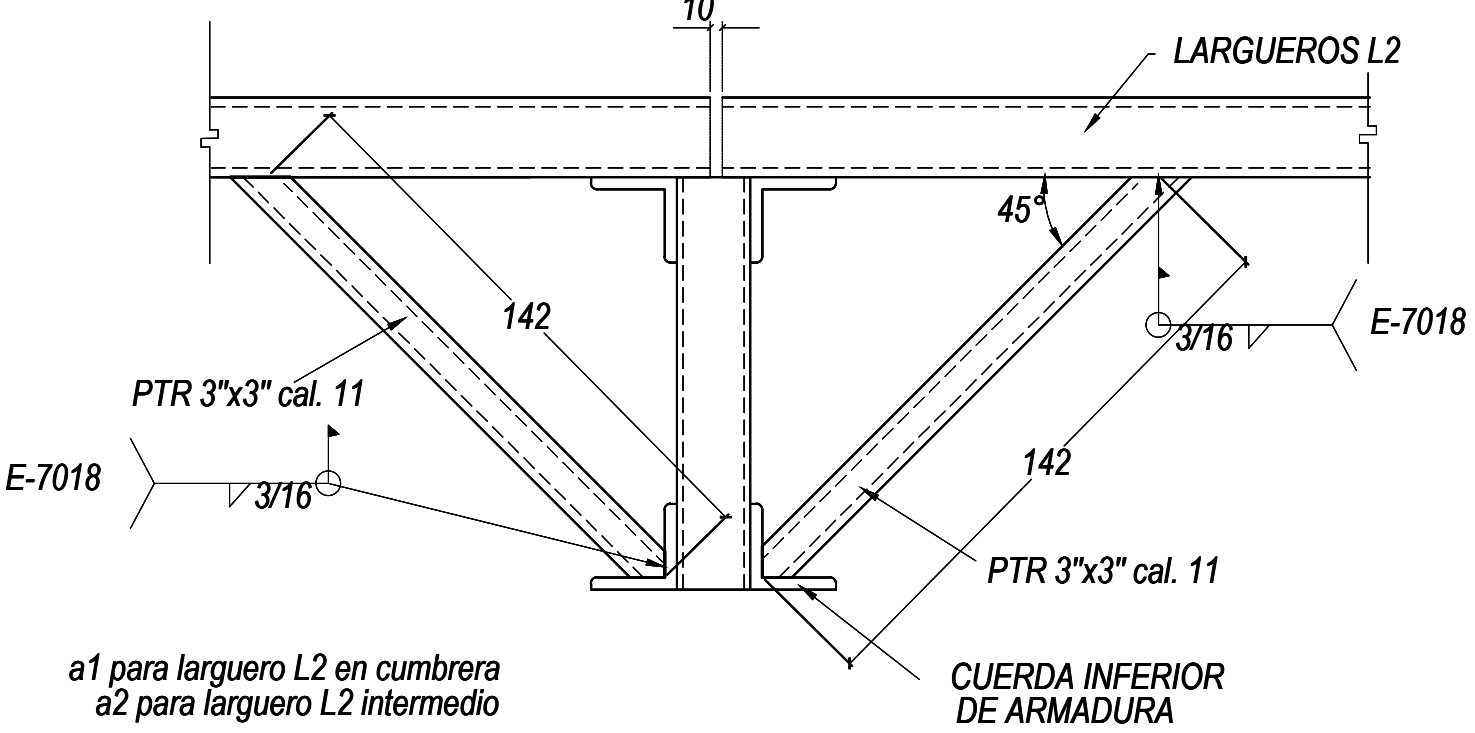

CASO 1
ARMADURA INTERMEDIO
(acot. mm)

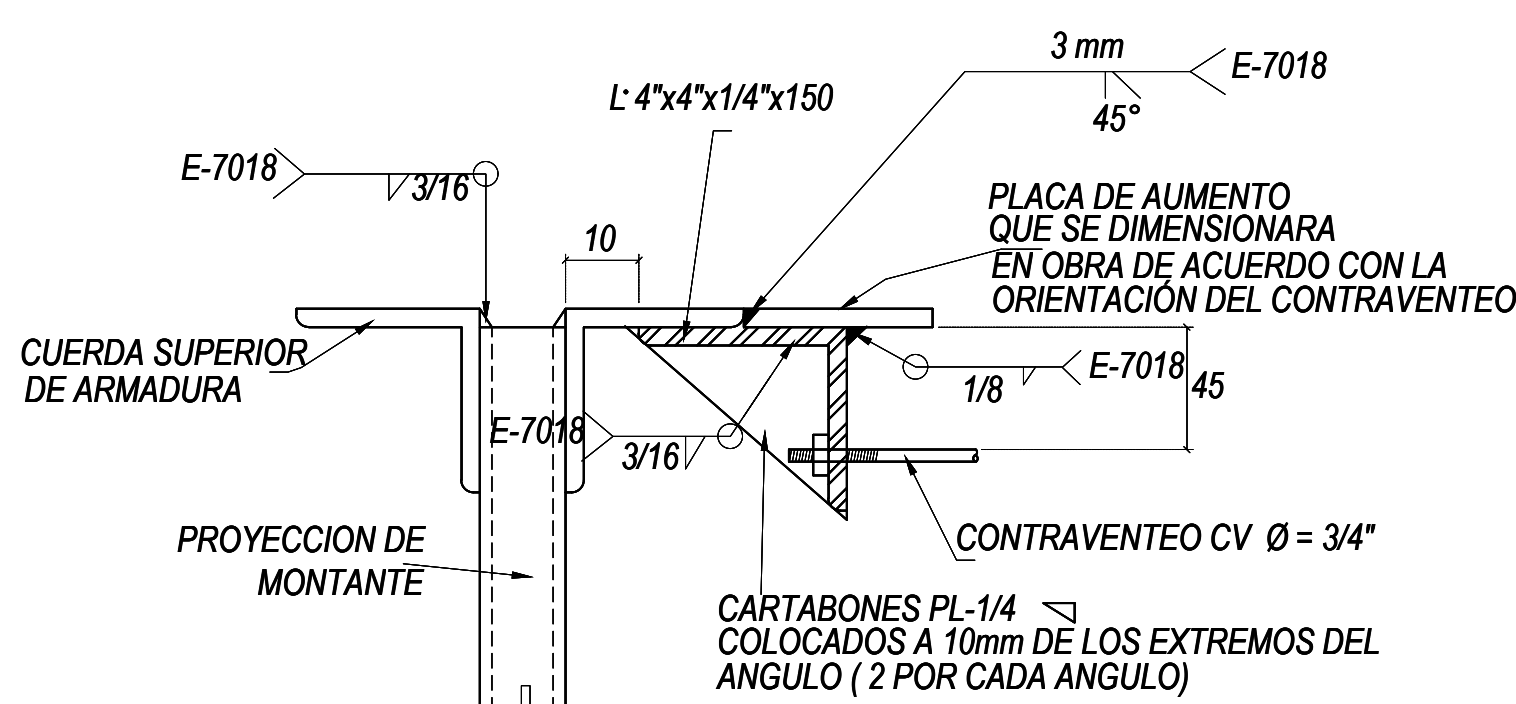

DETALLE 9 (ELEVACIÓN)
(CONEXION CONTRAVENTE A ARMADURAS)

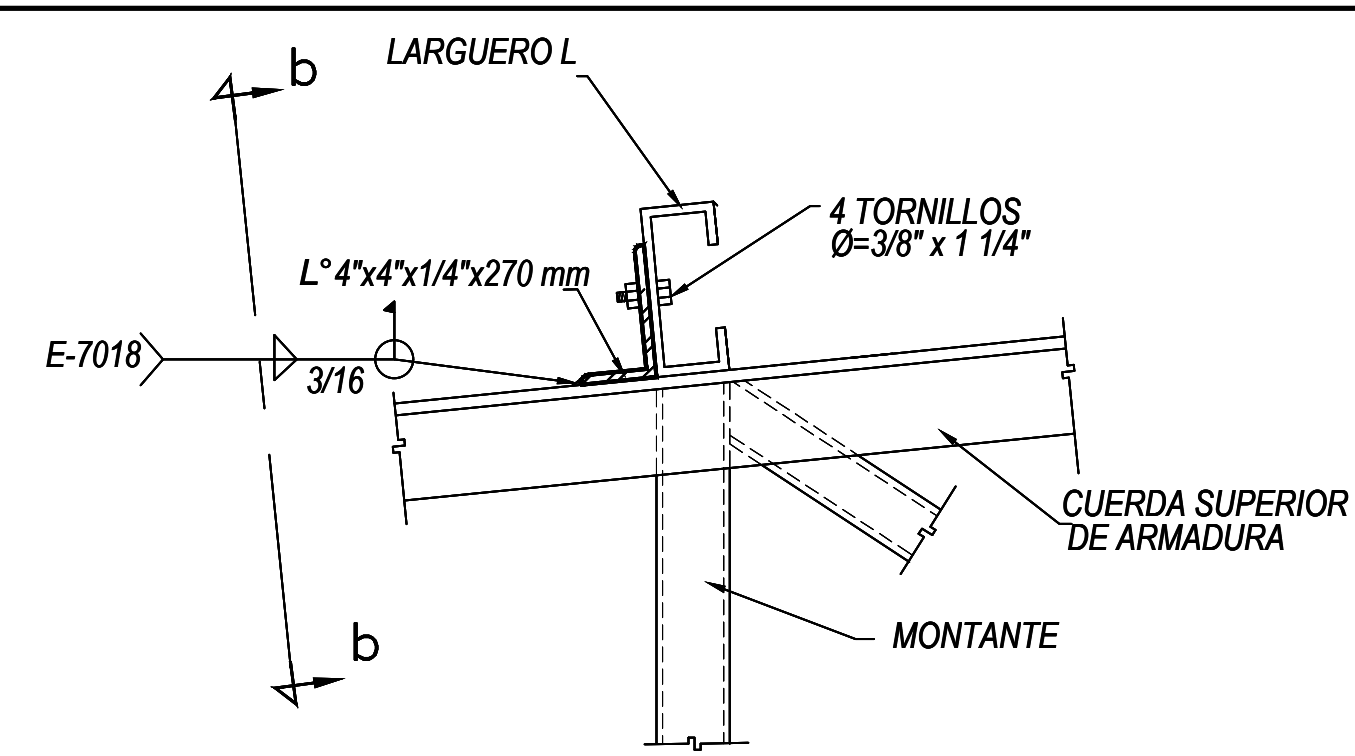

DETALLE 5
APOYO DE LARGUEROS EN ARMADURAS

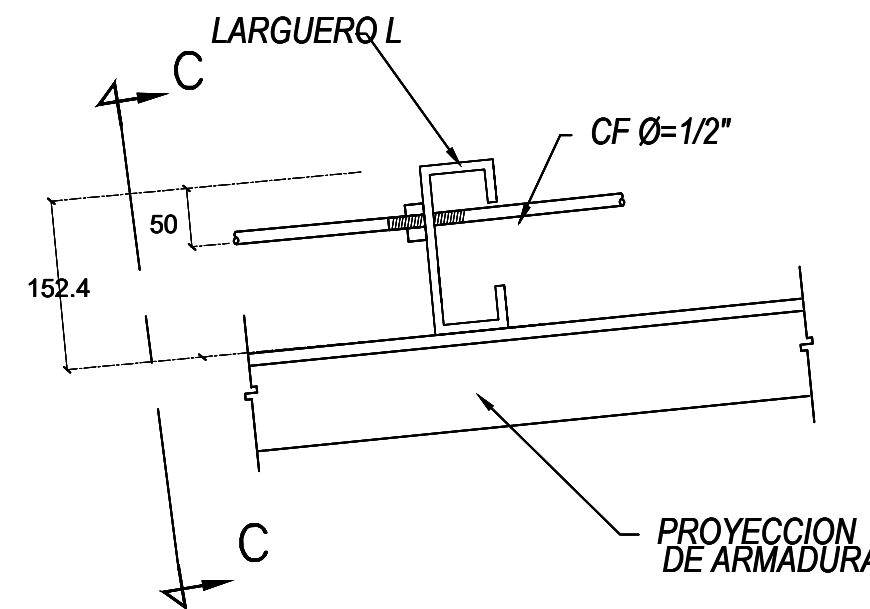

DETALLE 6
(acot. mm)

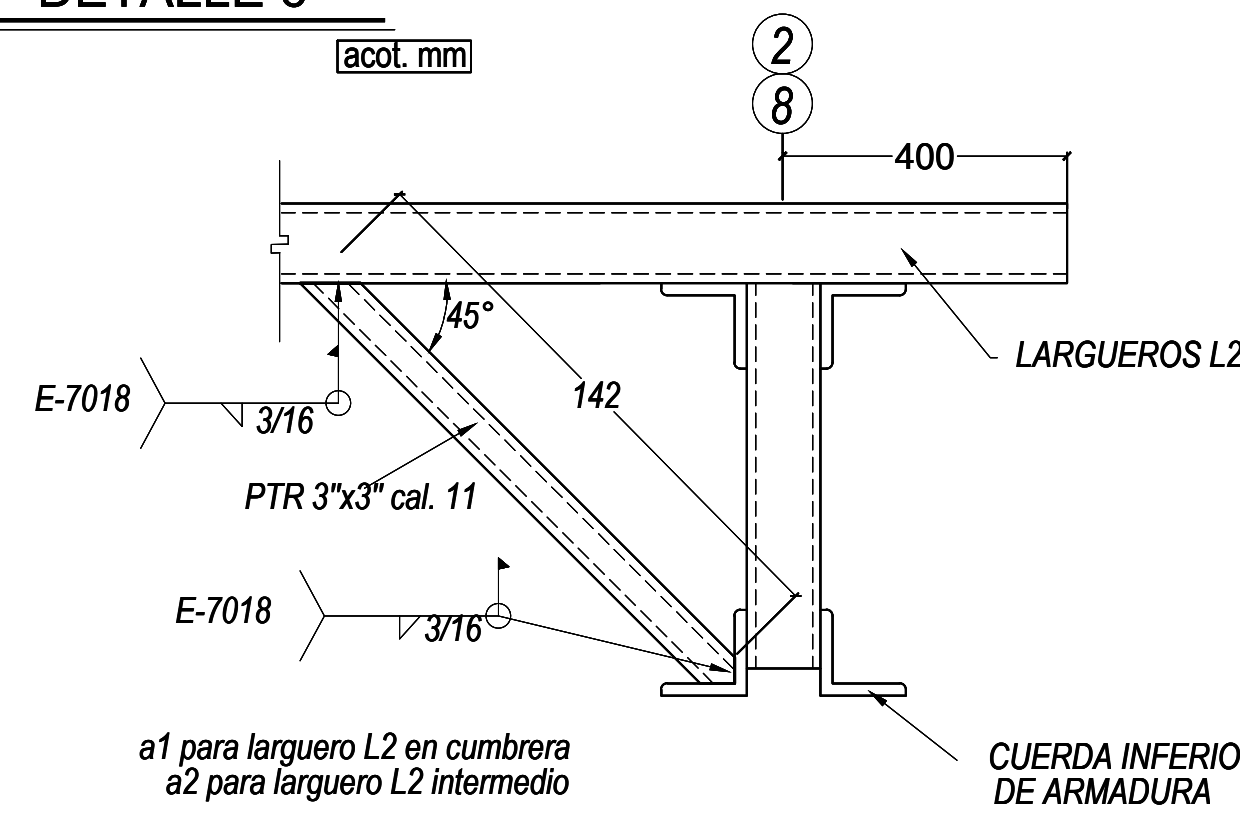

CASO 2
ARMADURA EN EXTREMO
(acot. mm)

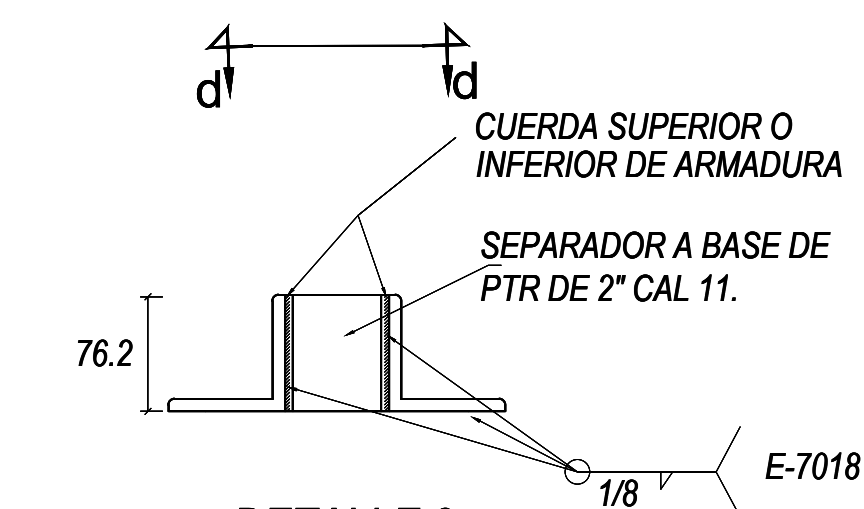

DETALLE 8
(SEPARADOR DE PTR EN CUERDAS SUPERIOR E INFERIOR DE ARMADURAS)

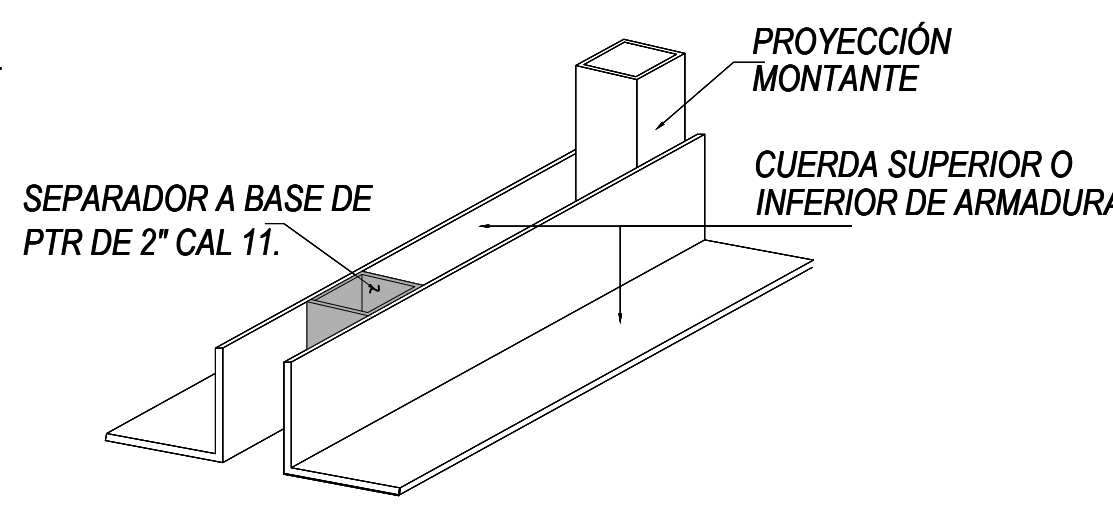

DETALLE 8
ISOMÉTRICO

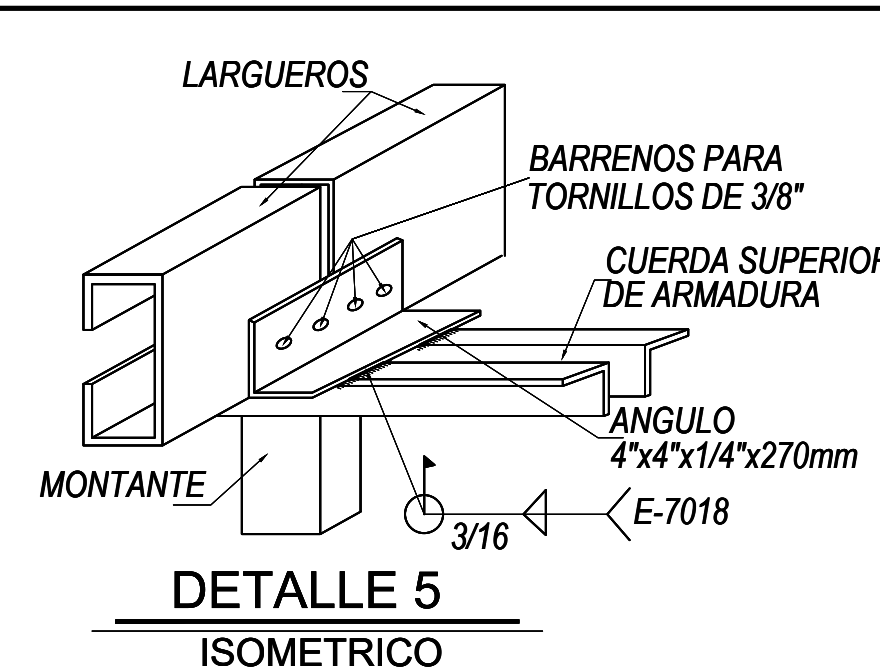

DETALLE 5
ISOMÉTRICO

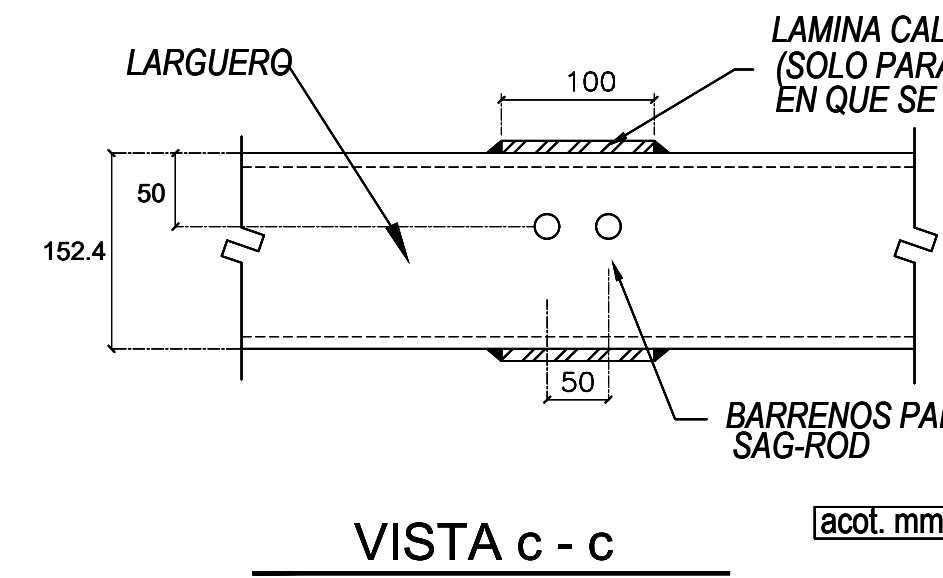

VISTA c - c
(acot. mm)

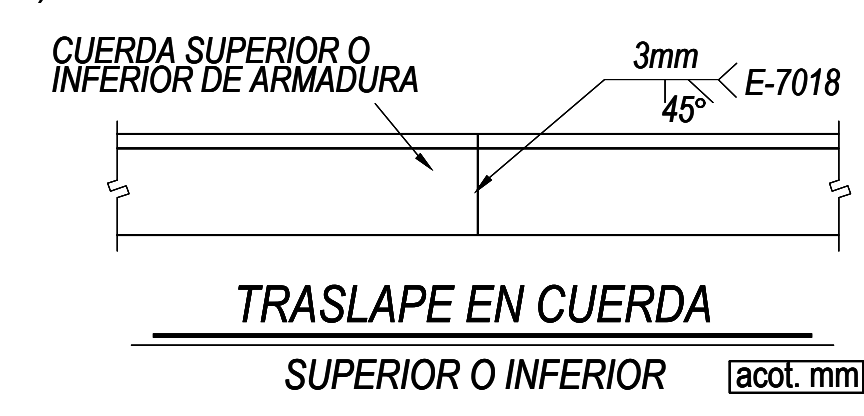

TRASLAPE EN CUERDA
SUPERIOR O INFERIOR
(acot. mm)

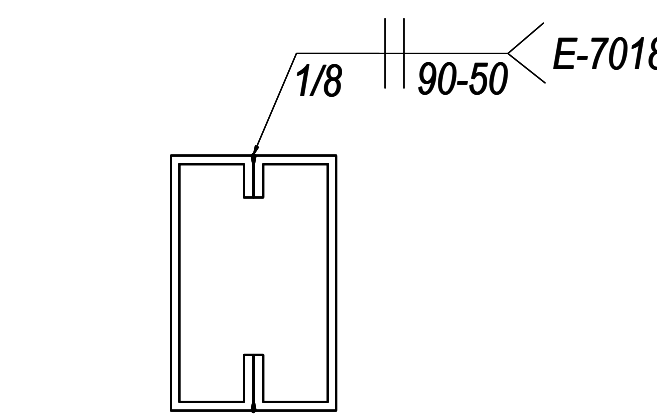

LARGUERO L2
CRITERIO PARA UNIR MONTENES

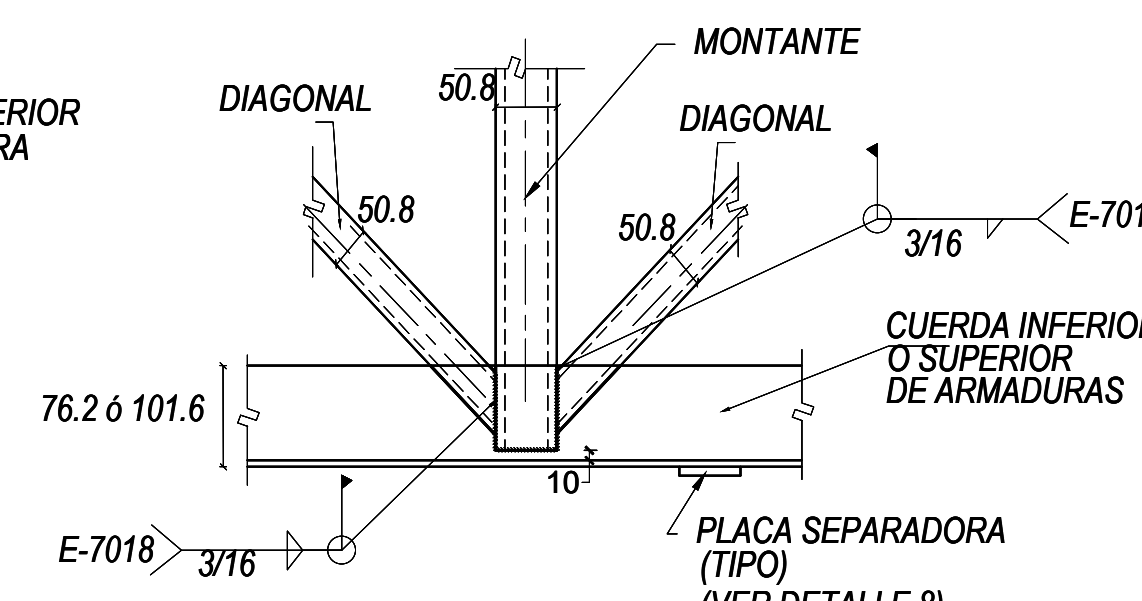

DETALLE 10
CRITERIO GENERAL PARA FORMAR ARMADURA A1
(acot. mm)

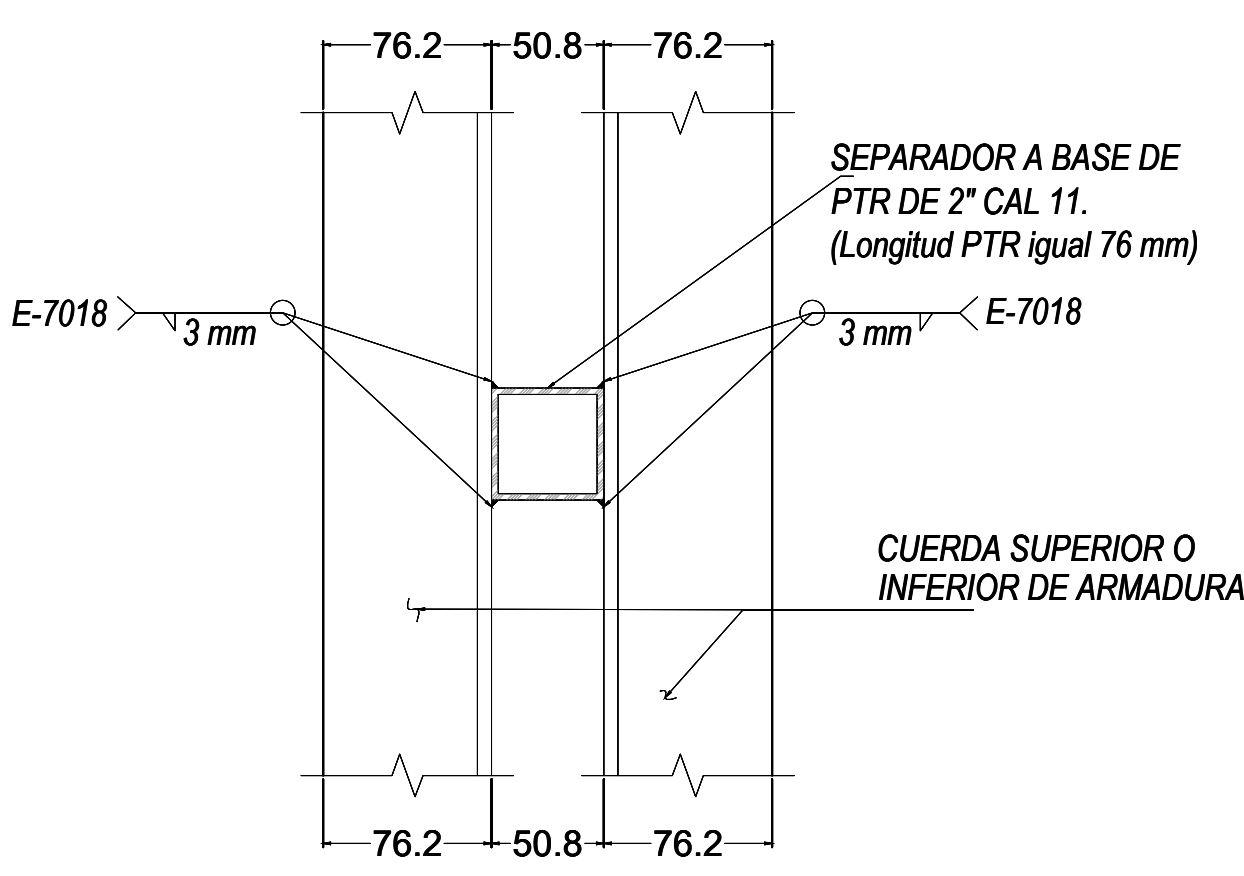

DETALLE 8
VISTA d-d

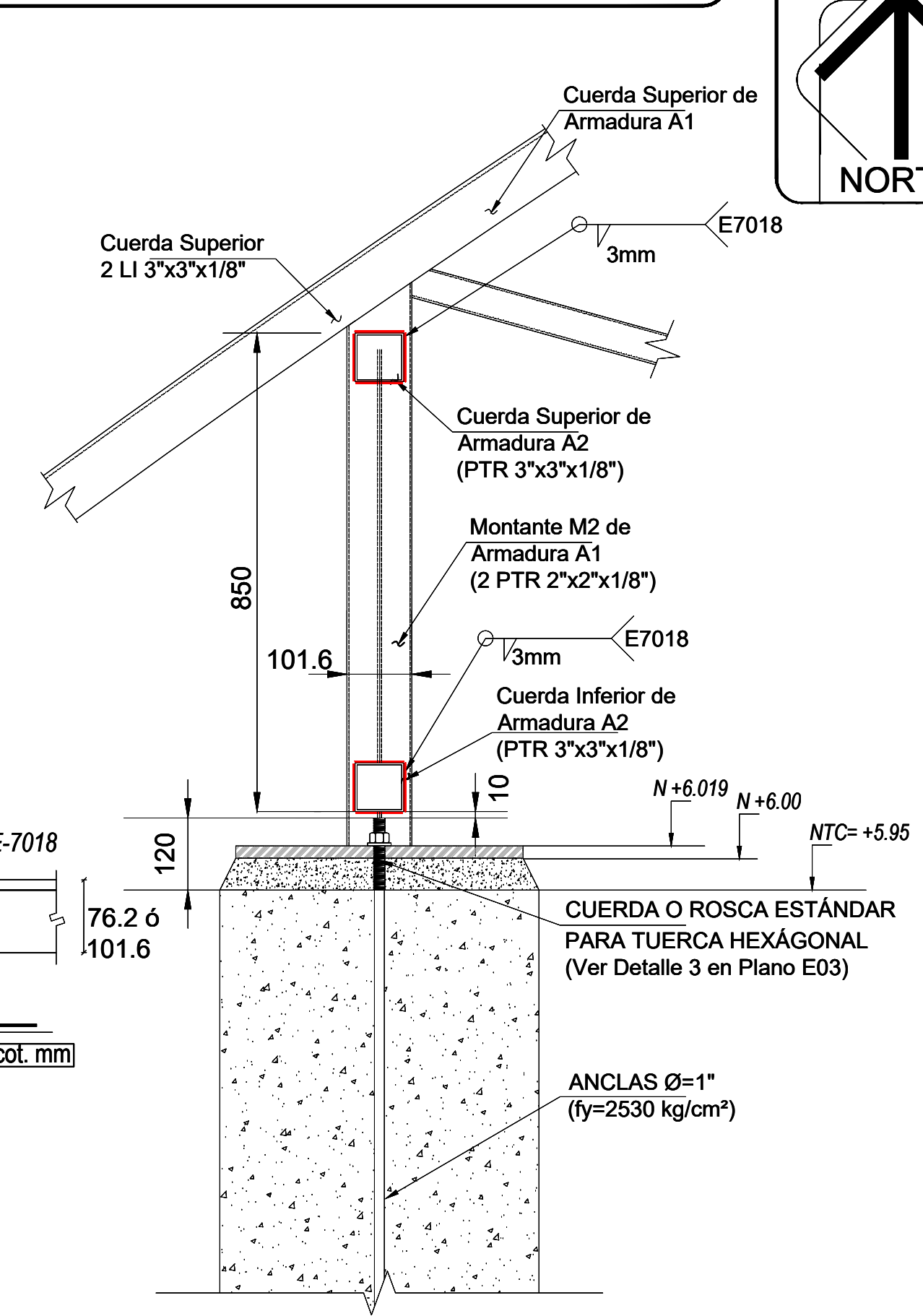

DETALLE 12
CONEXIÓN DE ARMADURA A2 (CUERDAS SUPERIOR E INFERIOR) A MONTANTE M2 DE ARMADURA A1

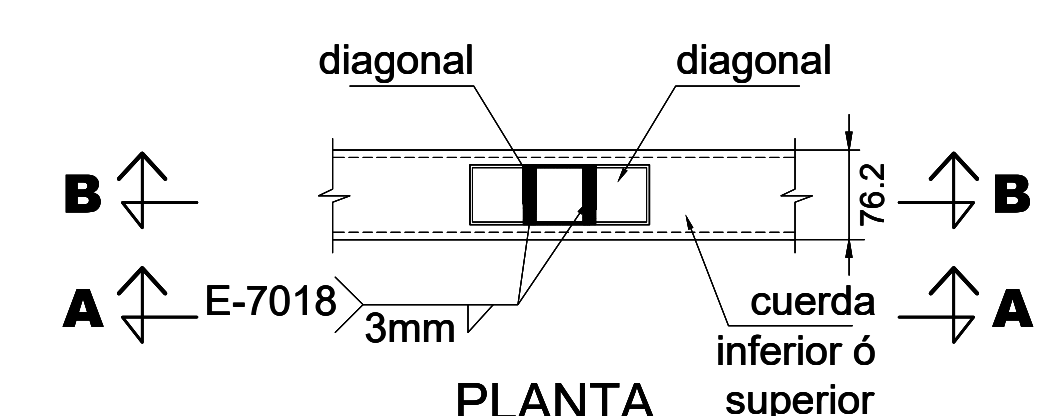

PLANTA

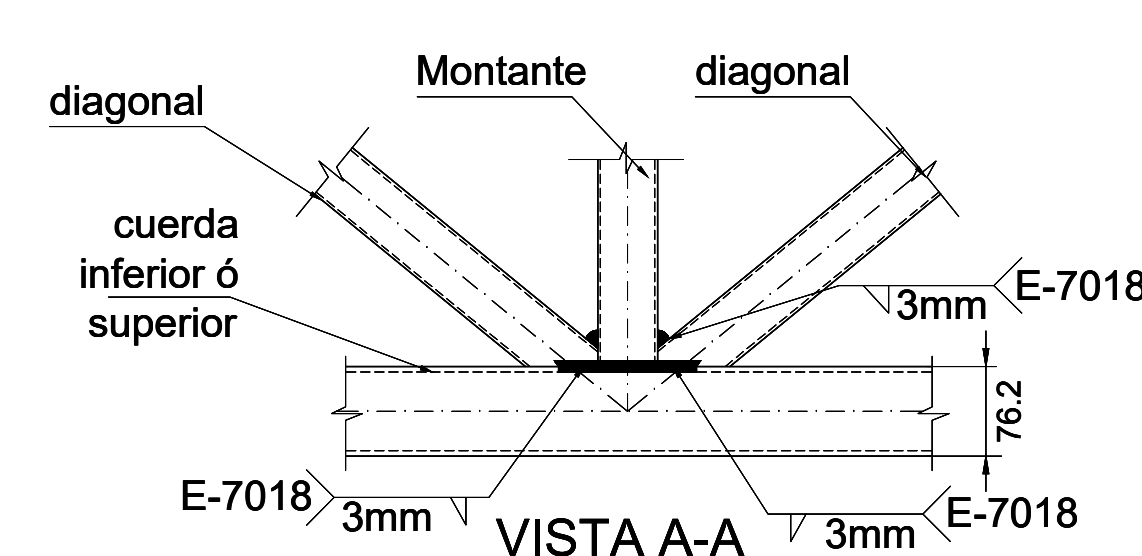

VISTA A-A

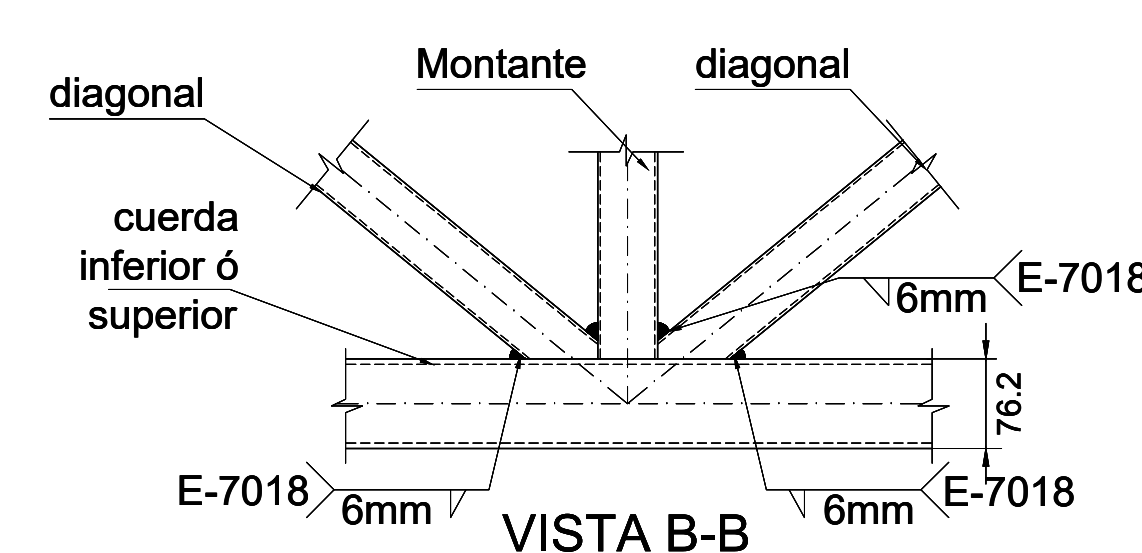

VISTA B-B

DETALLE 11
CRITERIO GENERAL PARA FORMAR ARMADURAS A2

